

VENUE SALES KIT

CELEBRATE WITH US!



Close proximity to major expressways and 5 minutes walk from Khatib MRT, the Clubhouse is easily accessible. Designed with versatility in mind, our event venue offers the ideal setting for any type of events, ranging from intimate gatherings to weddings. Our team of dedicated professionals will assist you in creating memorable experiences for you and your guests.



EVENT SPACES

CHARM YOUR GUESTS WITH AN UNFORGETTABLE EVENT AT OUR HIGHLY VERSATILE AND SLEEK EVENT SPACES. BRIGHTLY LIT WITH MODERN FURNISHING, IT BOASTS A WARM AND COZY AMBIENCE, MAKING IT A CONDUCIVE ENVIRONMENT FOR HOSTING YOUR EVENTS.



	FLOOR AREA (SQM)	CAPACITY (THEATRE STYLE)	CAPACITY (CLUSTER STYLE)
ZONE 1/2/3	105	100	60
ZONE 4	140	100	72
ZONE 1 + 2	210	200	120
ZONE 3 + 4	245	200	132

VENUE INCLUSIONS

- CONFIGURABLE LAYOUT
- BASIC SOUND SYSTEM
- PROJECTOR AND SCREEN
- WIRELESS MICROPHONES
- WRITABLE WALLS
- COMPLIMENTARY 1 HOUR FOR PRE SET-UP
- COMPLIMENTARY PARKING COUPONS (CAPPED)



AN IDEAL VENUE FOR

BIRTHDAY PARTYS, BABY SHOWERS, MEETINGS & WORKSHOPS

EVENT SPACES

FLOOR PLAN

@ LEVEL 4

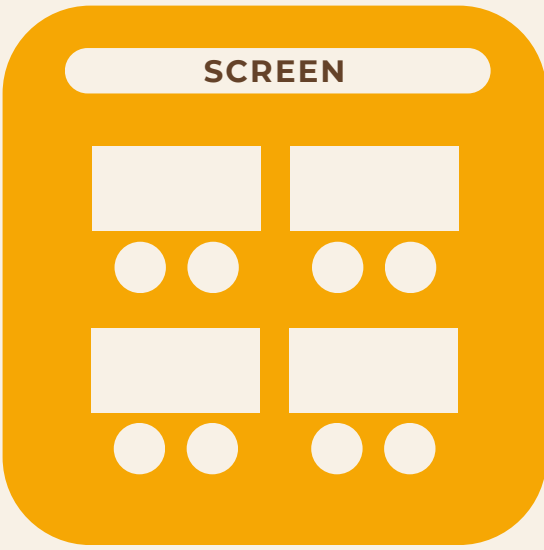
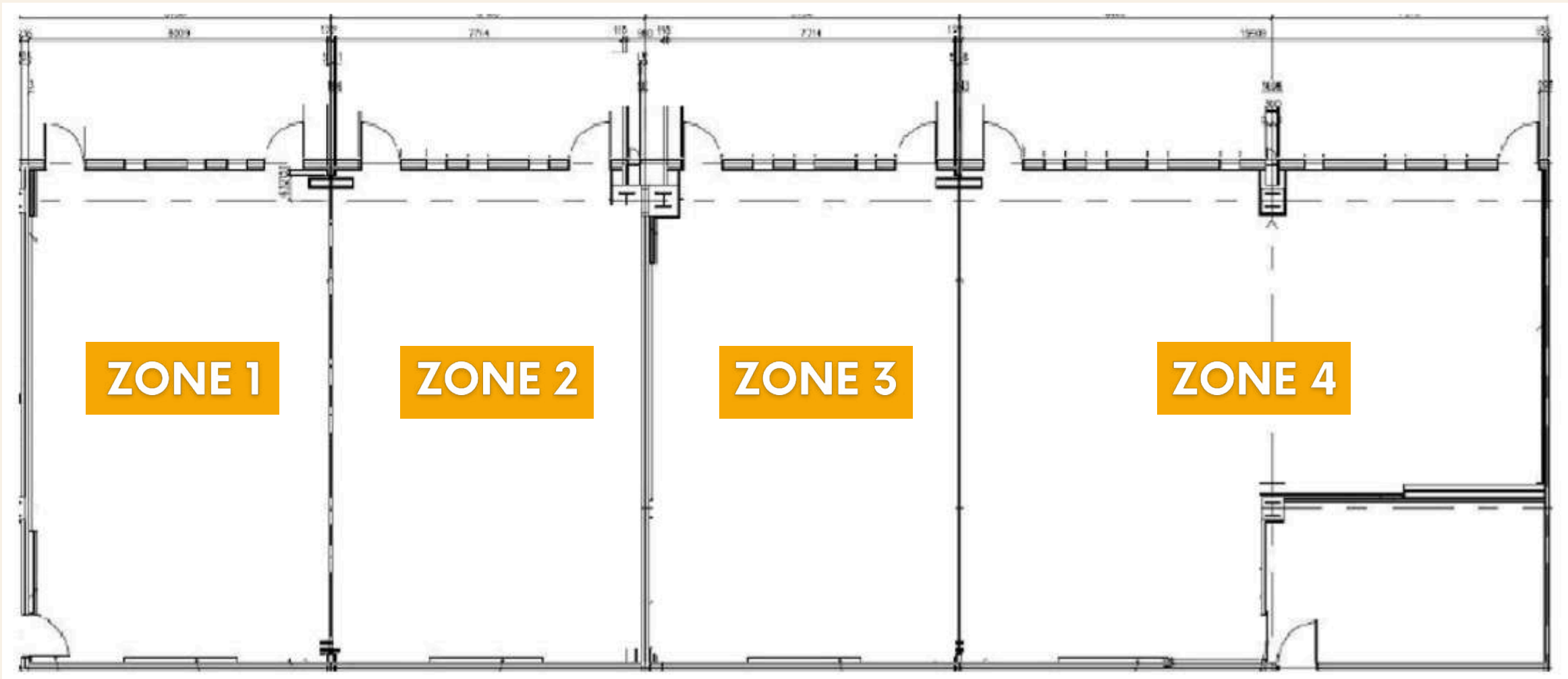

CLASSROOM

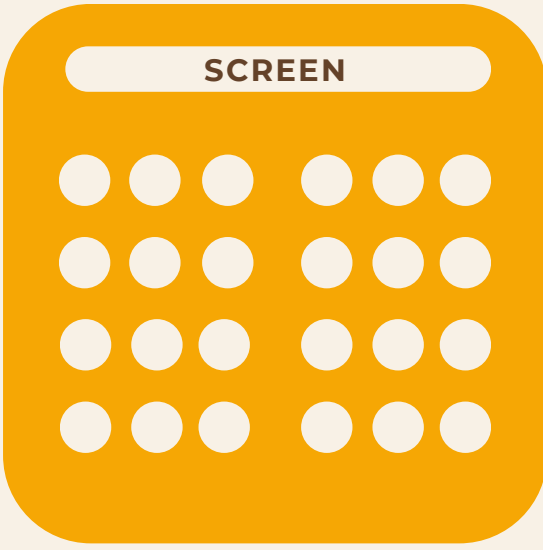

THEATRE

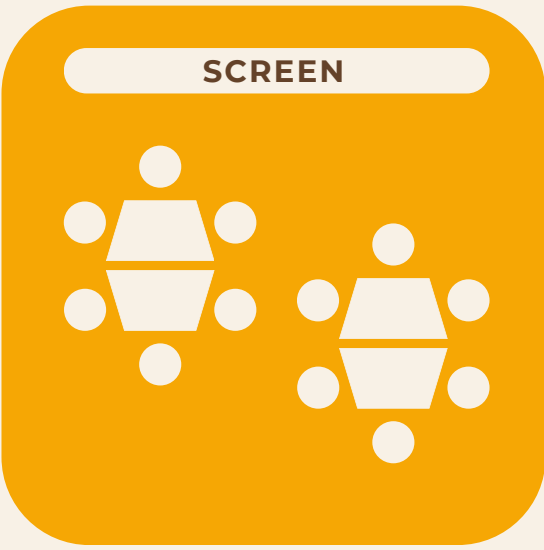

CLUSTER

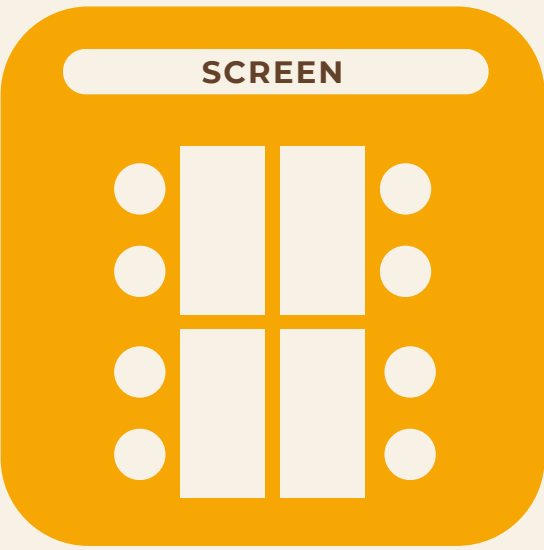

BOARDROOM

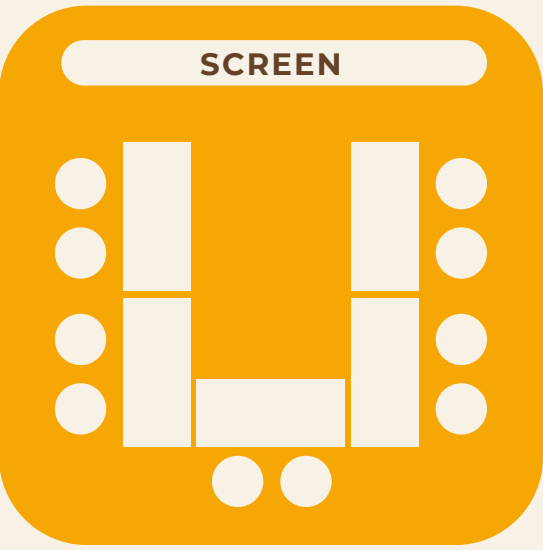

U-SHAPE

**Up to 6 pax per table*



BALLROOM

SPANNING OVER AN AREA OF 1,014 SQM, THE PILLAR FREE GRAND BALLROOM MAKES IT ONE OF THE BEST CHOICES FOR LARGE SCALE EVENTS. OUR GRAND BALLROOM CAN ALSO BE SEPARATED INTO INDIVIDUAL BALLROOM FOR INTIMATE CELEBRATIONS.

THE SPACIOUS FOYER WILL LET YOU EMBRACE THE URBAN LANDSCAPE THROUGH THE FLOOR TO CEILING WINDOWS WITH AN EXCLUSIVE POOL VIEW.

	FLOOR AREA (SQM)	CAPACITY (THEATRE STYLE)	CAPACITY (CLUSTER STYLE)
INIDIVIDUAL BALLROOM 1/2	507	400	240
GRAND BALLROOM	1,014	800	480

VENUE INCLUSIONS

- LOGISTIC SET UP OF BANQUET FURNITURES
- AUDIO VISUAL (AV) CAPABILITIES
- BRIDAL PRIVATE MAKE-UP ROOM (FOR WEDDING ONLY)
- USE OF FOYER
- COMPLIMENTARY 1 HOUR FOR PRE SET-UP
- COMPLIMENTARY PARKING COUPONS (CAPPED)
- COMPLIMENTARY SOUNDMAN

AN IDEAL VENUE FOR

WEDDINGS, SOLEMNIZATIONS, DINNER & DANCE, AWARD CEREMONIES

BALLROOM FLOOR PLAN

@ LEVEL 2

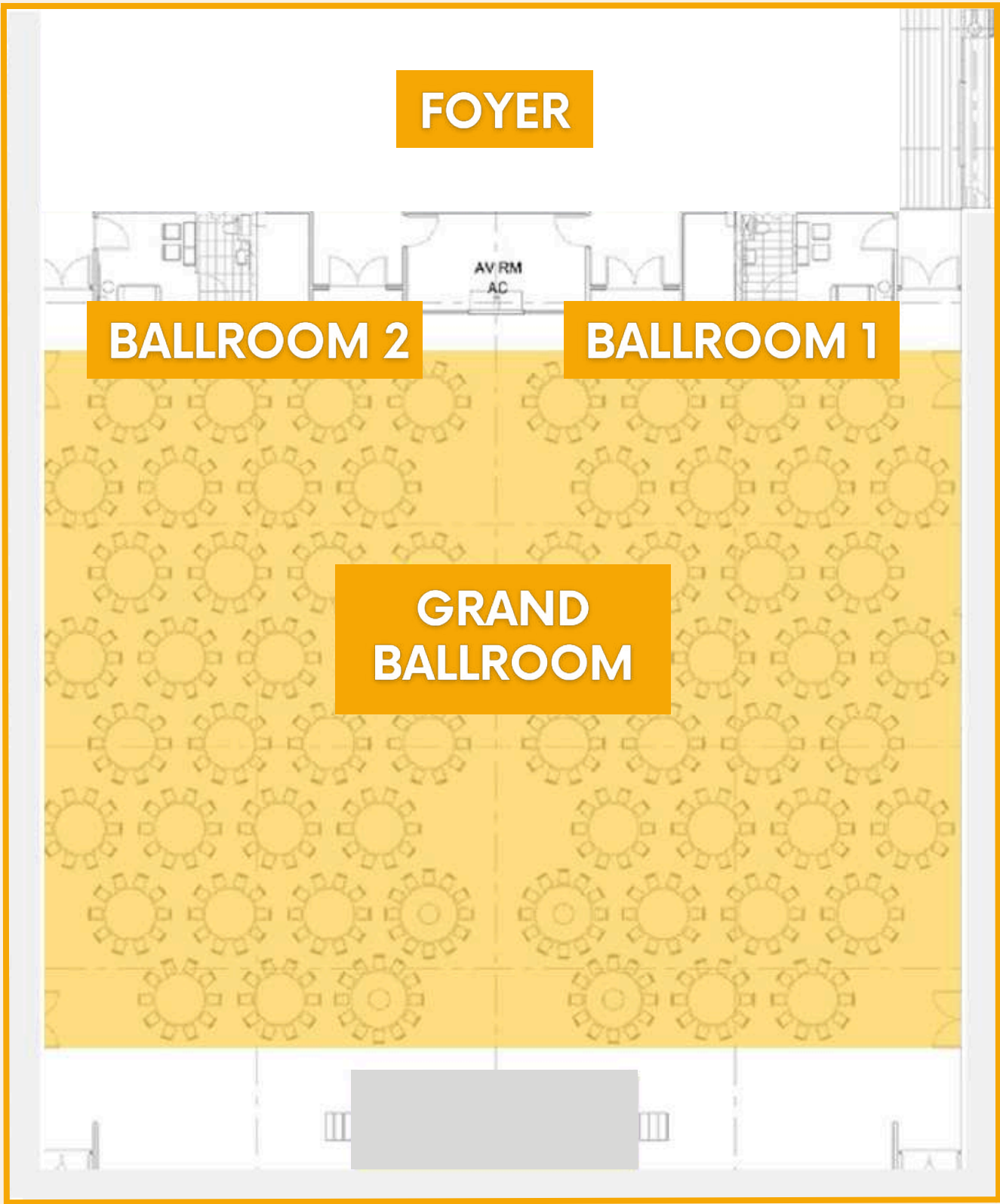

THEATRE STYLE



BANQUET STYLE

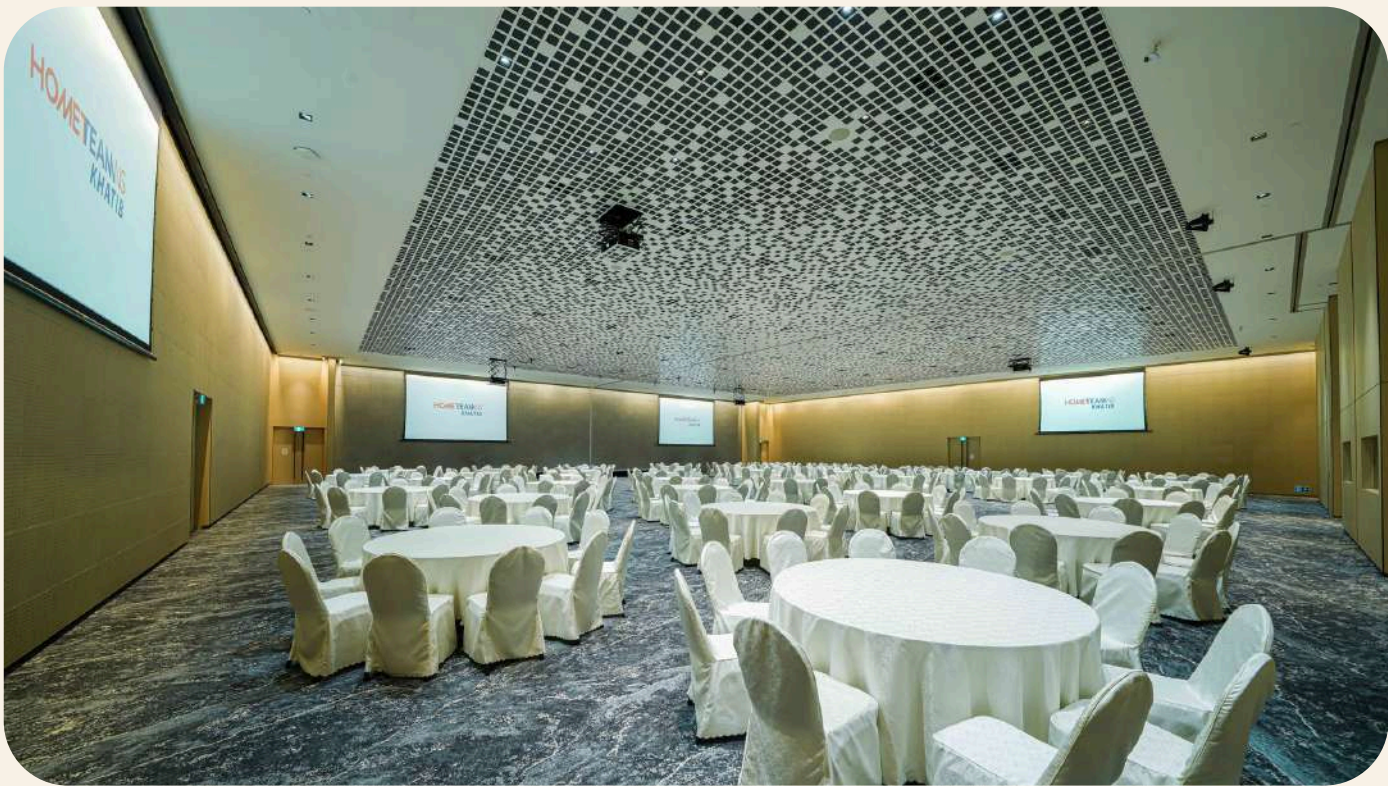

CATERING PARTNERS

FOR WEDDINGS

F&B catering is exclusively by our appointed caterers only.
For Event spaces bookings, external catering is allowed with a levy fee of **\$163.50**.



Amici Events
& Catering*



Bijan*



Bliss Garden
Restaurant*



Brinda's*



Cahaya Timur
Briyani House



Island Catering
Services*



Delizio
Catering*



Four Seasons
Catering*



Gayatri
Restaurant



Georges



How's Catering*



Gim Tim



Rajas Catering*



Kian Seng
Culinary



Kings Catering*



Lagun Sari*



Hariisa Catering*



Mamanda*



Rasel Catering*



Semmy's
Catering



Stamford
Catering*



Taste of India*



Shaabaz Kitchen*



Shiok Kitchen*

*Halal Certified

CATERING PARTNERS

FOR CORPORATE & PRIVATE EVENTS

F&B catering is exclusively by our appointed caterers only.
For Event spaces bookings, external catering is allowed with a levy fee of **\$163.50**.

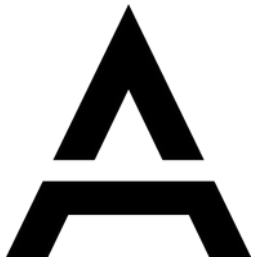

Amici Events
& Catering*



Bliss Garden
Restaurant*



Brinda's*



Island Catering
Services*



Delizio
Catering*



Four Seasons
Catering*



How's Catering*



KIAN SENG
CULINARY

Kian Seng
Culinary



Kings Catering*



LAGUN SARI

Lagun Sari*



MAMANDA®

Mamanda*



Rasel Catering*



Stamford
Catering*



Taste of India*



Shiok Kitchen
Catering*



Tim Delight*

CATERING PARTNERS

GOV AGENCIES DEMAND AGGREGATE (DA)

F&B catering is exclusively by our appointed caterers only.



Bliss Garden
Restaurant*



Brinda's*



Island Catering
Services*



Delizio
Catering*



Four Seasons
Catering*



How's Catering*



Rasel Catering*



Shiock Kitchen
Catering*



Stamford
Catering*



Tim Delight*

WHY CHOOSE US?



Easily Accessible by
Private and Public Transport



Ample Parking Space



Disable Friendly Facilities



Certified "Green Mark Platinum"
Sustainable and Eco Friendly Infrastructure



Unique and Versatile Event Space



Flexible Room Configuration



A Team of Dedicated Professionals



A Panel of Catering Partners

LOCATE US

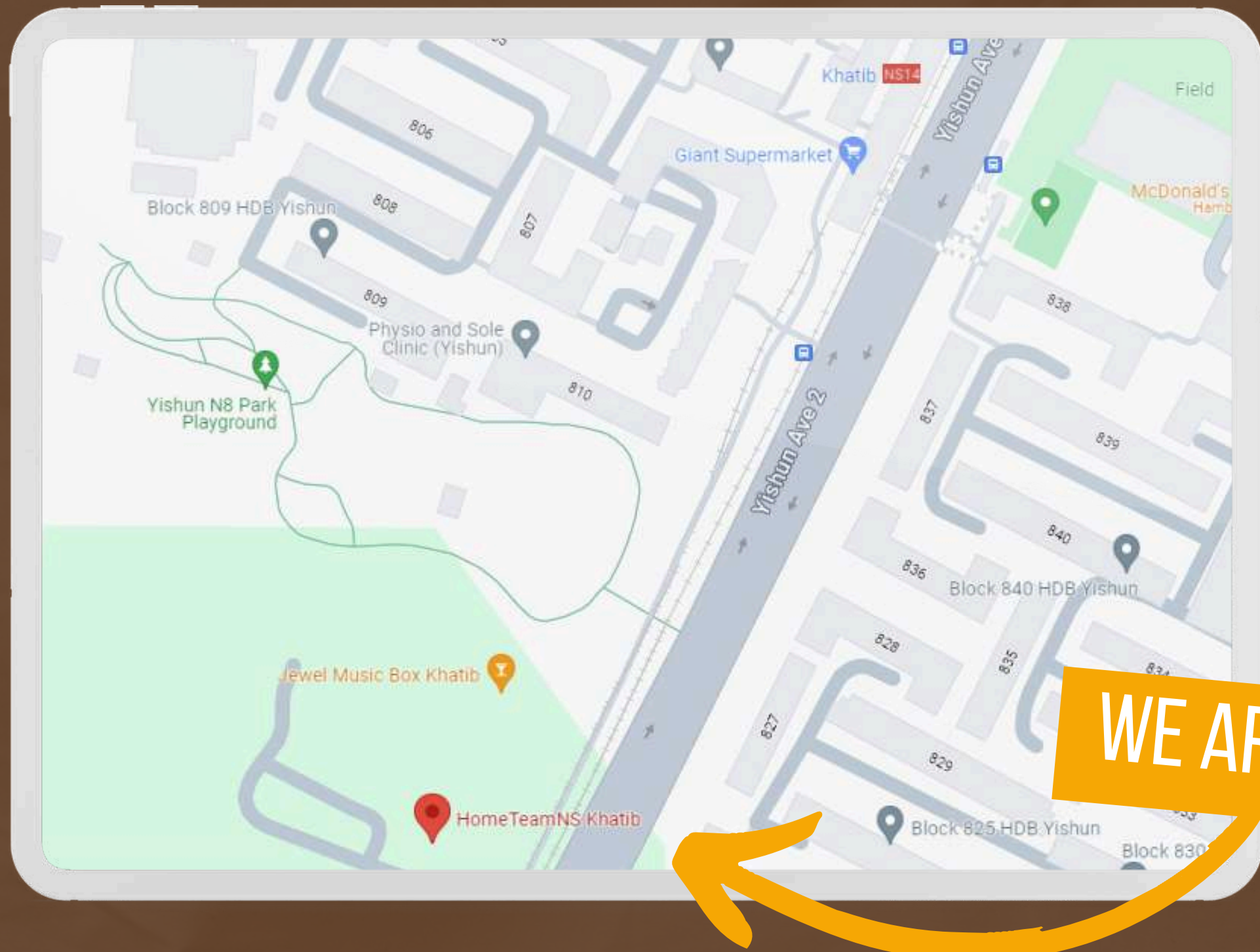

ADDRESS

2 Yishun Walk, Singapore 767944.

BY BUS

39, 85, 117, 851, 852, 854, 854, 855, 857, 858, 965, 969.

BY CAR

Along Yishun Avenue 2, turn left in 2 Yishun Walk.

BY TRAIN

Alight at Khatib MRT and exit via Exit B.

Walk along the park connector (directly below the train tracks) till you reach "Yishun Walk". Turn right at this road and you will get to our entrance.

PARKING CHARGES



CAR

MONDAY - SATURDAY

TIME	HOMETEAMNS	GUEST
6.01am - 5.00pm	\$1.28 first hour \$0.32/block of 15 min thereafter	\$1.70 first hour \$0.43/block of 15 min thereafter
5.01pm - 3.00am	\$2.08/entry	\$4.16/entry
3.00am - 6.00am	\$3.00/entry	\$3.90/entry

SUNDAY & PUBLIC HOLIDAY

TIME	HOMETEAMNS	GUEST
6.01am - 3.00am	\$2.08/entry	\$4.16/entry
3.01am - 5.00am	\$3.00/entry	\$3.90/entry



MOTORBIKE

MONDAY - SATURDAY & PUBLIC HOLIDAY

TIME	HOMETEAMNS	GUEST
ALL DAY	\$0.70/entry	\$0.91/entry



PAST
EVENTS

OUR PAST CLIENTS

MINISTRY OF HOME AFFAIRS (MHA)
MINISTRY OF SOCIAL AND FAMILY DEVELOPMENT (MSF)
MINISTRY OF EDUCATION (MOE)
MINISTRY OF DEFENCE (MINDEF)
MINISTRY OF CULTURE, COMMUNITY & YOUTH (MCCY)
SINGAPORE POLICE FORCE (SPF)
SINGAPORE CIVIL DEFENCE FORCE (SCDF)
CENTRAL NARCOTICS BUREAU (CNB)
IMMIGRATION & CHECKPOINTS AUTHORITY (ICA)
HOME TEAM SCIENCE AND TECHNOLOGY AGENCY (HTX)
LAND TRANSPORT AUTHORITY (LTA)
SMRT CORPORATION
THE ASSOCIATION OF BANKS IN SINGAPORE (ABS)
PEOPLE'S ASSOCIATION
NEE SOON TOWN COUNCIL
SINGAPORE RED CROSS SOCIETY
SINGAPORE HEART FOUNDATION
HEALTH PROMOTION BOARD (HPB)
KHOO TECK PUAT HOSPITAL (KTPH)
NATIONAL UNIVERSITY HOSPITAL (NUH)
FOOTBALL ASSOCIATION OF SINGAPORE
AGENCY FOR INTEGRATED CARE PTE LTD
SINGAPORE INDIAN DEVELOPMENT ASSOCIATION (SINDA)
MASJID AL-IMAN
MAJLIS UGAMA ISLAM SINGAPURA (MUIS)
YAYASAN MENDAKI
ITE EDUCATION SERVICES
SINGAPORE TAMIL TEACHERS' UNION
SINGAPORE INSTITUTE OF TECHNOLOGY
SINGAPORE EXAMINATIONS AND ASSESSMENT BOARD (SEAB)
ST ENGINEERING PTE LTD
ST LOGISTICS PTE LTD

6708 6670 

venues_kt@hometeamns.sg 

Facebook.com/HomeTeamNSKhatib 

<https://www.hometeamns.sg/khatib/> 

GET IN TOUCH WITH US

